

Name: 8 2.0EU Kit Vehicle Setup

Date:

Event:

City:

State:

Track:

Track Conditions ☐ Indoor ☐ Tight ☐ Smooth ☐ Hard Packed ☐ Blue Groove ☐ Wet ☐ Low Bite ☐ High Bite ☐ Outdoor ☐ Open ☐ Rough ☐ Loose/Loamy ☐ Dry ☐ Dusty ☐ Med Bite ☐ Other _____

Front Suspension

Toe: 2.5 degrees of toe-out

Ride Height: 24mm

Camber: -2 degree

Caster: Stock (22 degrees)

Sway Bar: 2.5mm

Piston/Oil: 55/37.5 wt Losi

Spring: Silver 4.4 lb

Limiter/Droop: 95mm

Overall Shock Length: 95mm

Steering Ackerman: Long

Bump Steer: Down

Camber Link: 2/A

Shock Location: 1/Inside

Receiver Battery Type: Losi LiPo

Differentials

Front: ☒ Standard ☐ Smart

Spring Wire Dia: _____

Qty of Springs: _____

Ramp Plate: _____

Grease: _____

Diff Fluid: 7000 wt Losi

Center: ☒ Standard ☐ Smart

Spring Wire Dia: _____

Qty of Springs: _____

Ramp Plate: _____

Grease: _____

Diff Fluid: 5000 wt Losi

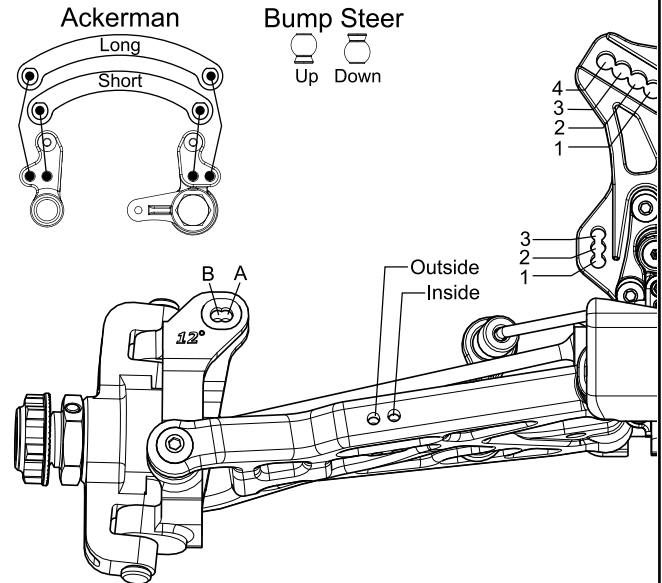

Notes: _____

Rear Suspension

Toe: 3 degrees

Anti-Squat: 3 degrees

Ride Height: 28mm

Camber: -2 degrees

Rear Hub Spacing: Back

Sway Bar: 2.3mm

Piston/Oil: 55/32.5 wt Losi

Spring: Silver 2.8lb

Limiter/Droop: 107mm

Overall Shock Length: 107mm

Camber Link: 2/B

Shock Location: 1/Inside

Rear Diff Fluid: 2000 wt Losi

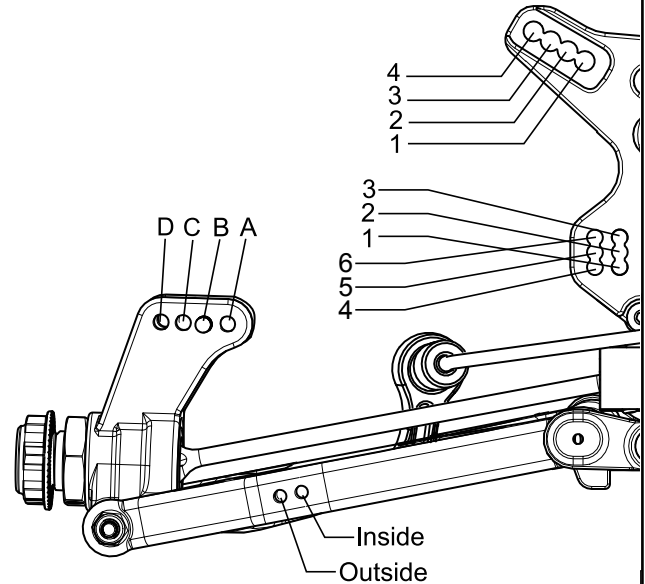

Notes: _____

Engine

Engine: _____ Fuel: Nitrotane 30%

Glow Plug: _____ Head Clearance: _____

Pipe/Header: _____ Gearing: 13/46

Clutch

Clutch Shoes and Springs Info

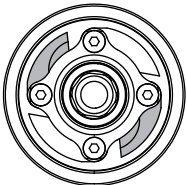

2 Composite with Green Springs

2 Aluminum with Green Springs

Aluminum Flywheel

Tires

Type

Compound

Insert

Front: _____

Rear: _____

Notes: _____

