

UL 19 Hydroplane

PRB08028

30-INCH BRUSHLESS RTR

**Owners Manual • Bedienungsanleitung
Manuel de l'utilisateur • Manuale dell'utente**

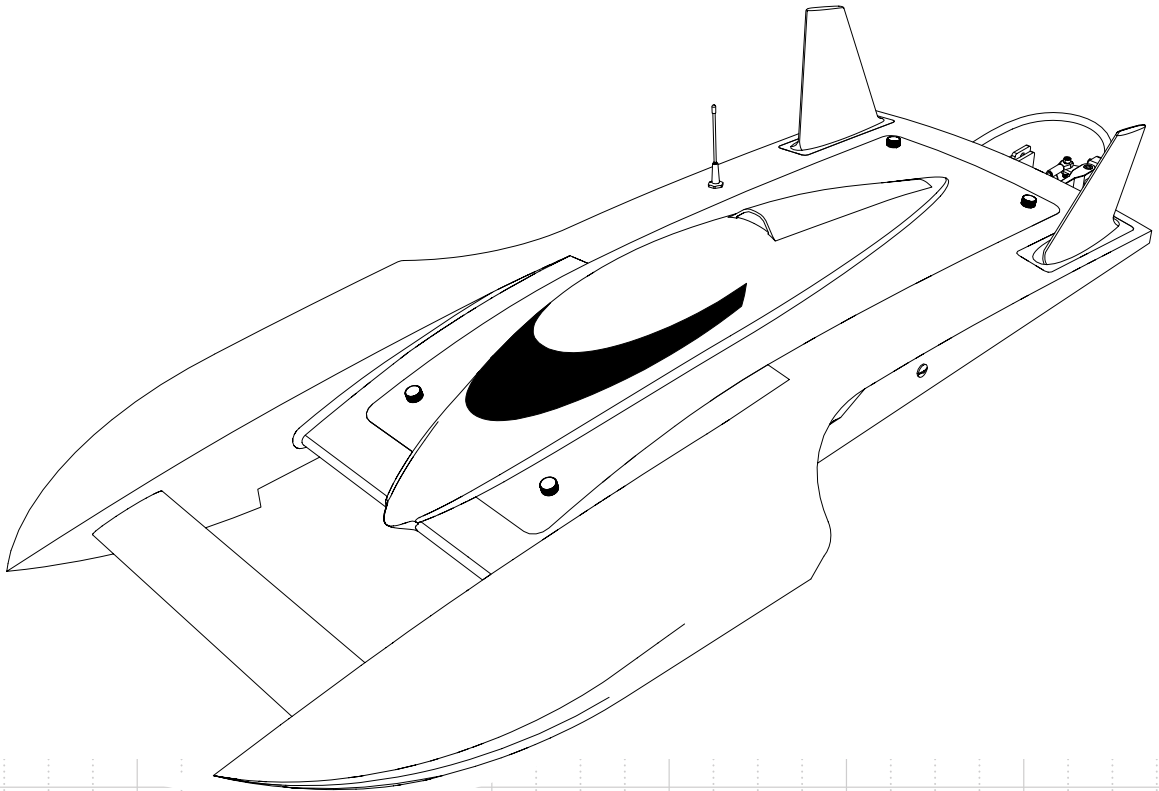

NOTICE

All instructions, warranties and other collateral documents are subject to change at the sole discretion of Horizon Hobby, LLC. For up-to-date product literature, visit <http://www.horizonhobby.com> and click on the support tab for this product.

MEANING OF SPECIAL LANGUAGE

The following terms are used throughout the product literature to indicate various levels of potential harm when operating this product:

WARNING: Procedures, which if not properly followed, create the probability of property damage, collateral damage, and serious injury OR create a high probability of superficial injury.

CAUTION: Procedures, which if not properly followed, create the probability of physical property damage AND a possibility of serious injury.

NOTICE: Procedures, which if not properly followed, create a possibility of physical property damage AND little or no possibility of injury.



WARNING: Read the ENTIRE instruction manual to become familiar with the features of the product before operating. Failure to operate the product correctly can result in damage to the product, personal property and cause serious injury.

This is a sophisticated hobby product and NOT a toy. It must be operated with caution and common sense and requires some basic mechanical ability. Failure to operate this Product in a safe and responsible manner could result in injury or damage to the product or other property. This product is not intended for use by children without direct adult supervision. Do not use with incompatible components or alter this product in any way outside of the instructions provided by Horizon Hobby, LLC. This manual contains instructions for safety, operation and maintenance. It is essential to read and follow all the instructions and warnings in the manual, prior to assembly, setup or use, in order to operate correctly and avoid damage or serious injury.

Age Recommendation: Not for children under 14 years. This is not a toy.

Safety Precautions and Warnings

As the user of this product, you are solely responsible for operating in a manner that does not endanger yourself and others or result in damage to the product or the property of others.

- When handling and/or transporting your boat, always pick up the boat from the sides, keeping all moving parts pointed away from you.
- Always keep a safe distance in all directions around your model to avoid collisions or injury. This model is controlled by a radio signal subject to interference from many sources outside your control. Interference can cause momentary loss of control.
- Always operate your model in open spaces away from full-size vehicles, traffic and people.
- Always carefully follow the directions and warnings for this and any optional support equipment (chargers, rechargeable battery packs, etc.).
- Always keep all chemicals, small parts and anything electrical out of the reach of children.
- Always avoid water exposure to all equipment not specifically designed and protected for this purpose. Moisture causes damage to unprotected electronics.
- Never place any portion of the model in your mouth as it could cause serious injury or even death.
- Never operate your model with low transmitter batteries.

Table of Contents

| | | | |
|--|---|--|----|
| Water-Resistant Boat with Waterproof Electronics | 3 | After Boating and Maintenance | 10 |
| General Precautions | 3 | Binding | 10 |
| Wet Conditions Maintenance | 3 | Motor Care | 10 |
| Specifications | 3 | Water Cooling System | 11 |
| Recommended Tools and Materials | 4 | Rudder Service | 11 |
| Battery Charger | 4 | Propeller Service | 11 |
| Boat Stand Assembly | 4 | Propeller Strut Depth Adjustment | 11 |
| Antenna Tube Installation | 4 | Drivetrain Lubrication | 12 |
| Canopy Removal | 5 | ESC Programming | 12 |
| Installing the Battery Packs | 5 | Troubleshooting Guide | 13 |
| Spektrum DX2E Radio System | 6 | Limited Warranty | 14 |
| Battery Charger | 6 | Warranty and Service Contact Information | 15 |
| Low Voltage Cutoff (LVC) | 7 | FCC Information | 15 |
| Battery Chemistry | 7 | IC Information | 15 |
| Getting Started | 7 | EU Compliance Statement | 15 |
| Control Check | 8 | Instructions for Disposal of WEEE | 15 |
| Testing Your Boat in the Water | 8 | Replacement Parts | 58 |
| Boating Tips | 9 | Recommended Parts | 58 |
| When You Are Finished | 9 | Optional Parts | 59 |

Water-Resistant Boat with Waterproof Electronics

Your new Horizon Hobby boat has been designed and built with a combination of waterproof and water-resistant components to allow you to operate the product in calm, fresh water conditions.

While the entire boat is highly water-resistant, it is not completely waterproof and your boat should NOT be treated like a submarine. The various electronic components used in the boat, such as the servo(s) and receiver are waterproof, however, most of the mechanical components are water-resistant and require additional maintenance after use.

Metal parts, including the bearings, pins, screws and nuts, propeller, rudder, rudder mounts, prop struts, as well as the contacts in the electrical cables, will be susceptible to corrosion if additional maintenance is not performed after running in wet conditions. To maximize the long-term performance of your boat and to keep the warranty intact, the procedures described in the "Wet Conditions Maintenance" section must be performed regularly.

CAUTION: Failure to exercise caution while using this product and complying with the following precautions could result in product malfunction and/or void the warranty.

General Precautions

- Read the **WET CONDITIONS MAINTENANCE** procedures and make sure that you have all the tools you will need to properly maintain your boat.
- Not all batteries can be used in wet conditions. Consult the battery manufacturer before use. Caution should be taken when using Li-Po batteries in wet conditions.
- Most transmitters are not water-resistant. Consult your transmitter's manual or the manufacturer before operation.
- Never operate your transmitter or boat when lightning is present.
- Salt water is very conductive and highly corrosive. If you choose to run your boat in salt water, immediately rinse the boat in fresh water after each use. Operating your boat in salt water is at the sole discretion of the modeler.

Wet Conditions Maintenance

- Drain any water that has collected in the hull by removing the drain plug or canopy and tilting the boat in the appropriate direction to drain the water.

CAUTION: Always keep hands, fingers, tools and any loose or hanging objects away from rotating parts.

- Remove the battery pack(s) and dry the contacts. If you have an air compressor or a can of compressed air, blow out any water that may be inside the recessed connector housings.
- Remove all moving parts. Dry and lubricate parts after every 30 minutes of operation or if the boat becomes submerged.

NOTICE: Never use a pressure washer to clean your boat.

- Use an air compressor or a can of compressed air to dry the boat and help remove any water that may have gotten into small crevices or corners.
- Spray the bearings, fasteners and other metal parts with a water-displacing light oil or lubricant.
- Let the boat air dry before you store it. Water (and oil) may continue to drip for a few hours.

Specifications

| | |
|----------------------|---|
| Length | 30 in (762mm) |
| Height | 6 in (152.4mm) |
| Transmitter | DX2E (SPM2330) |
| Receiver | SR310 3-CH Sport Receiver (SPMSR310) |
| Hull Material | Fiberglass |
| Motor | 2000Kv 6-Pole 3650 Marine Motor (DYNAM3831) |
| ESC | 120A Brushless Marine ESC 2-6S (DYNAM3875) |
| Servo | 3KG, Plastic Gear Servo, WP, 23T (SPMS603) |

Tip: 4 AA batteries (sold separately) are required to operate the transmitter.

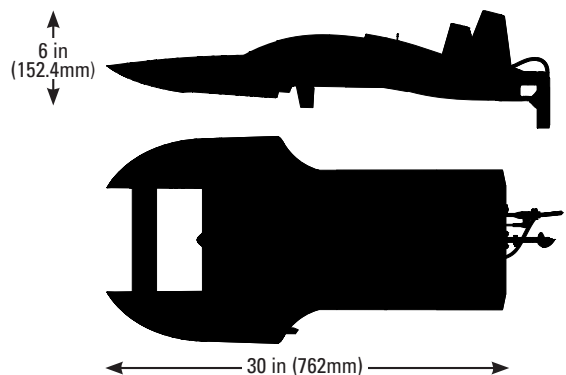

Recommended Tools and Materials

- Needle nose pliers
- Paper towel
- Rubbing alcohol
- Open-end wrench: 10mm (2)
- Nut driver: 4mm, 7mm, 8mm
- Phillips screwdriver: #1
- Hex wrench: 1.5mm, 2mm, 2.5mm, 3mm
- Clear tape (DYNAM0102)
- Pro Boat® Marine Grease and Gun (DYNE4200)
- Hook and Loop Tape Set, WP 4pcs (DYNK0300)

Product Inspection

Carefully remove the boat and radio transmitter from the box. Inspect the boat for damage. If your product is damaged, please contact the hobby shop where you purchased your boat, or contact Horizon Hobby Product Support. Refer to the Warranty and Service Contact Information section for more info.

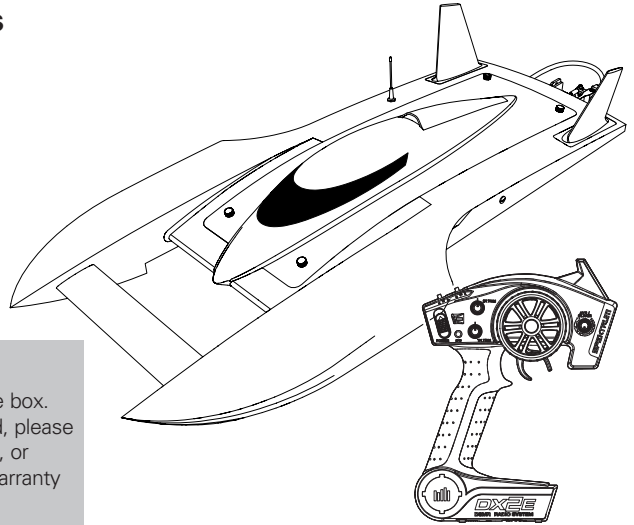

Boat Stand Assembly

1. Attach the side stand pieces to the end pieces as shown.
2. Use medium CA or epoxy adhesive to secure the side stand to the ends.
3. Allow the adhesive to dry before placing your boat on the stand.

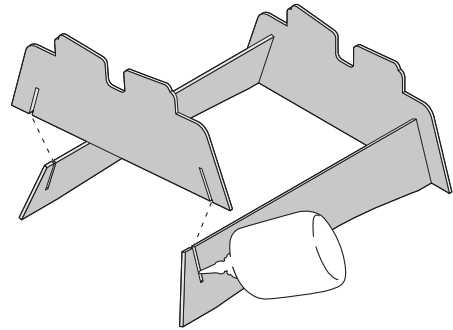

Antenna Tube Installation

1. Carefully feed the end of the receiver antenna through the grommet inside the hull.
2. Pull the antenna wire out of the grommet toward the outside of the boat, then slide the antenna through the antenna tube.
3. Insert the tube into the grommet, then fit the cap onto the tube.
4. Slide the clear 20mm waterproof sleeve over the grommet and hull and install the tube into the sleeve.

The antenna must be installed above the boat's waterline to get the best reception of your transmitter's signal.

NOTICE: Do not cut or kink the receiver antenna or damage may result.

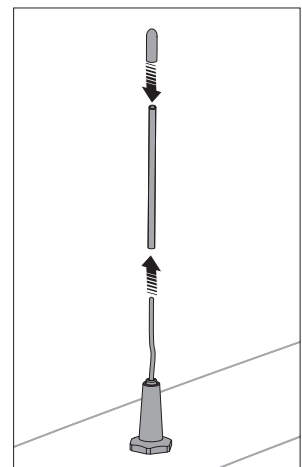

Canopy Removal

1. Loosen the 4 screws located at each corner of the canopy.
2. Remove the canopy from the hull starting with the 2 rear screws. Ensure that the 4 screws have disengaged from their bases before carefully lifting the canopy.

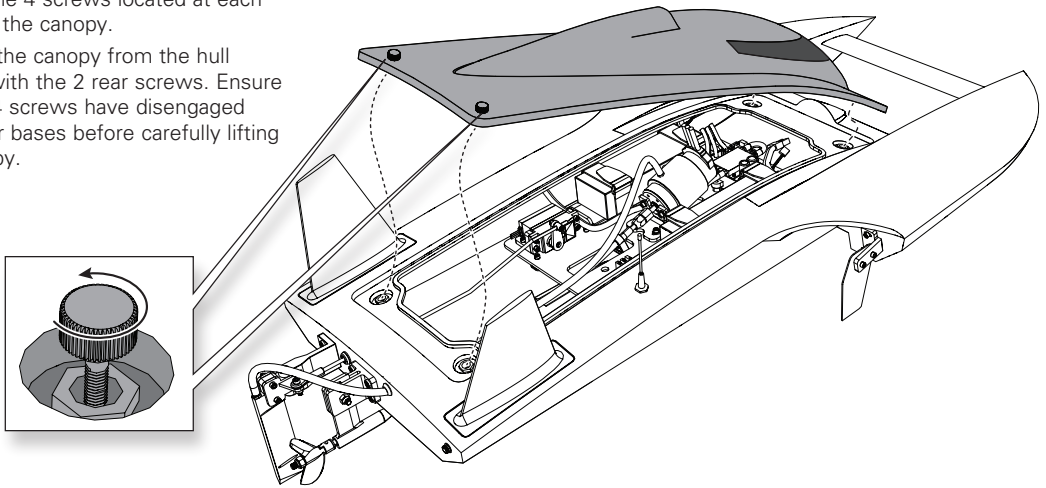

Installing the Battery Packs

The included electronics are rated for 2S–6S LiPo batteries; however, running the stock propeller nonstop on a 6S battery could overheat your electronics or damage your batteries. If you run the stock propeller on 6S, we recommend using full throttle on straight line passes only. Return passes should be at half throttle to reduce the heat of the electronics. If you want to run 6S nonstop, use optional propellers (PRB282006 or PRB282027).

1. Install the 2 battery packs on the left and right sides of the boat hull. Secure the batteries with the included hook and loop straps. When running your boat in rough water, use Waterproof Hook and Loop Tape (DYNK0300) between the batteries and the battery tray to secure the batteries more fully.

Tip: Start with the batteries as far forward as possible, moving them 1/4 inch at a time toward the bow until your boat reaches maximum speed.

2. Connect each battery pack to the ESC power connectors.

The included propeller provides the best performance between 4S (14.8V) and 5S LiPo (18.5V). 5S configuration can be achieved by mounting a 3S LiPo battery (DYNB3811EC) on the left side of the boat and a 2S LiPo battery (DYNB3810EC) on the right side of the boat. The added weight of the 3S battery on the left side will counteract torque twist caused by the propeller spinning at high RPM.

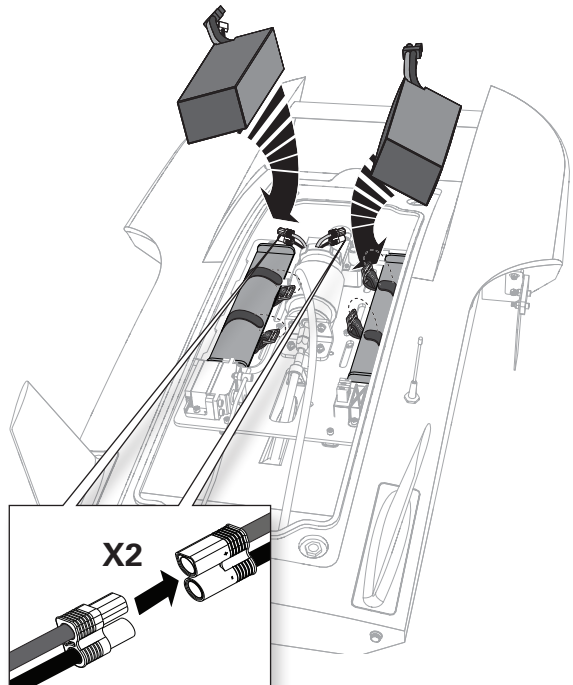

WARNING: When using 2 batteries in series, always make sure they are in roughly the same condition (age) and they have the same capacity (mAh) and discharge rate (C rating). Failure to do so may cause damage to your batteries, potentially causing a fire.

Spektrum DX2E Radio System

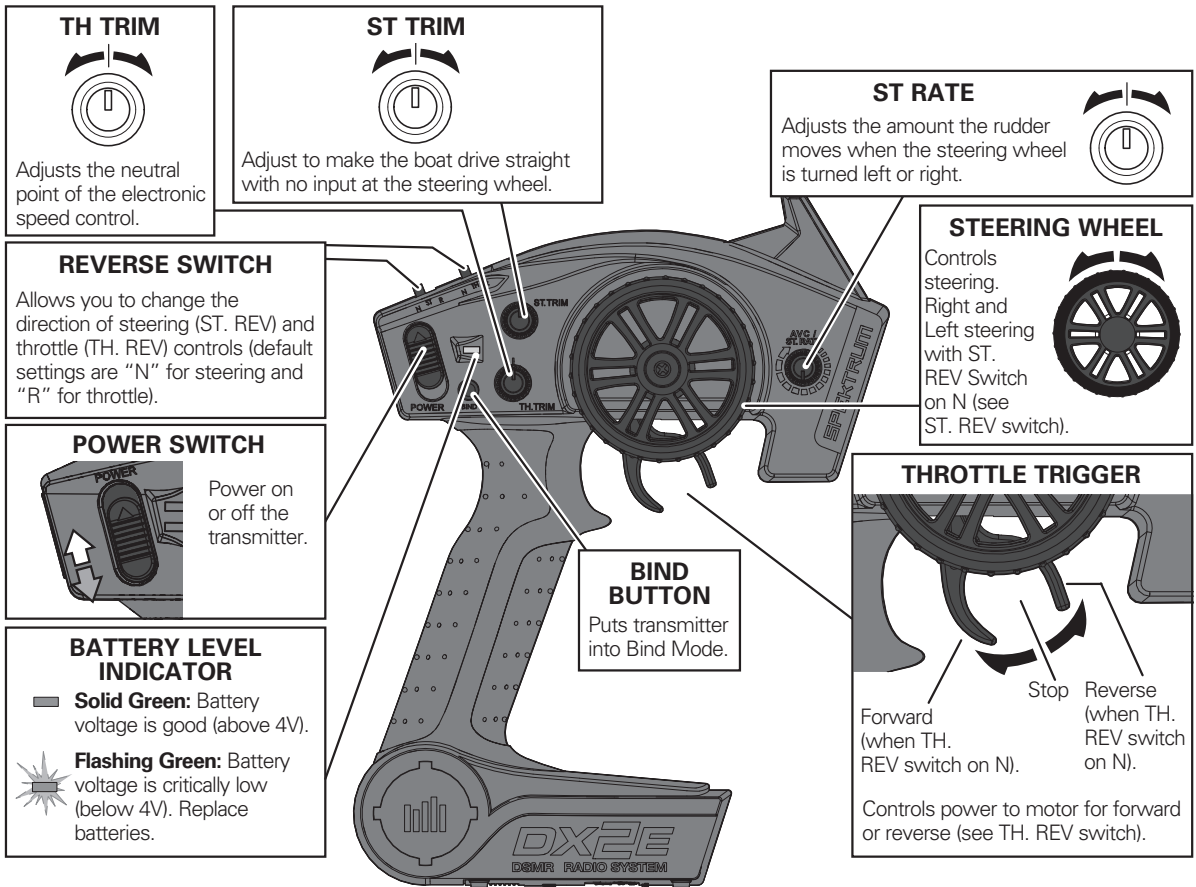

Transmitter Battery Installation

This transmitter requires 4 AA batteries.

1. Remove the battery cover from the transmitter.
2. Install the batteries as shown.
3. Install the battery cover.

CAUTION: If using rechargeable batteries, charge only rechargeable batteries. Charging non-rechargeable batteries may cause the batteries to burst, resulting in injury to persons and/or damage to property.

CAUTION: Risk of explosion if battery is replaced by an incorrect type. Dispose of used batteries according to national regulations.

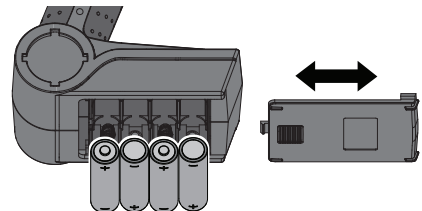

Battery Charger

Choose a charger designed to charge the recommended Dynamite[®] Reaction[®] HD7.6V 5000mAh 2S 50C LiPo Hardcase: EC5 battery or the Dynamite[®] Reaction[®] HD 11.4V 5000mAh 3S 50C LiPo, Hardcase: EC5 battery. We recommend the Dynamite[®] Passport[™] Ultra 100W AC/

DC Touch battery charger (DYNC3000). Refer to your charger manual for charging instructions and safety information.

NOTICE: Never charge a battery in the boat or damage may result.

Low Voltage Cutoff (LVC)

Discharging a Li-Po battery below 3V per cell may damage your battery. The included ESC protects the boat battery from over-discharge using Low Voltage Cutoff (LVC). Before the battery charge decreases too much, LVC removes power supplied to the motor. Power to the motor pulses, showing that some battery power is reserved for boat control and safe landing.

Disconnect and remove the Li-Po battery from the boat after use to prevent trickle discharge. Charge your Li-Po battery to about half capacity before storage. During storage, make sure the battery charge does not fall below 3V per cell. LVC does not prevent the battery from over-discharge during storage.

NOTICE: Repeated operation to LVC will damage the battery.

Tip: Monitor your boat battery's voltage before and after boating by using a Li-Po Cell Voltage Checker (DYN4071, sold separately).

Battery Chemistry

The ESC comes from the factory in Li-Po Mode. To change battery chemistry:

1. Keep the throttle at neutral and power ON the ESC.
2. Press and hold the Battery Chemistry Button on the power switch for 3 seconds. The LED flashes the current battery chemistry (red = Ni-MH or Ni-Cd; green = Li-Po).
3. Continue holding the Battery Chemistry Button for another 6 seconds. The ESC changes battery chemistry and the LED flashes the new battery chemistry.
4. Power OFF the ESC. The ESC saves the setting until it is changed.

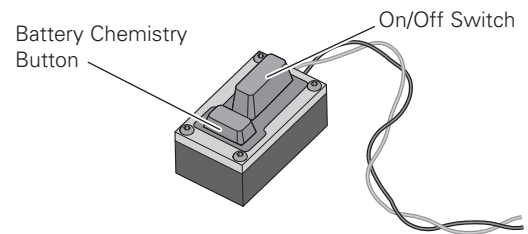

Getting Started

1. Power on the transmitter.
2. Connect the two batteries to the EC5™ connectors on the ESC.
3. Power on the ESC switch. The ESC arming tones will sound.
4. Test the transmitter's control of the boat with the boat on the display stand.

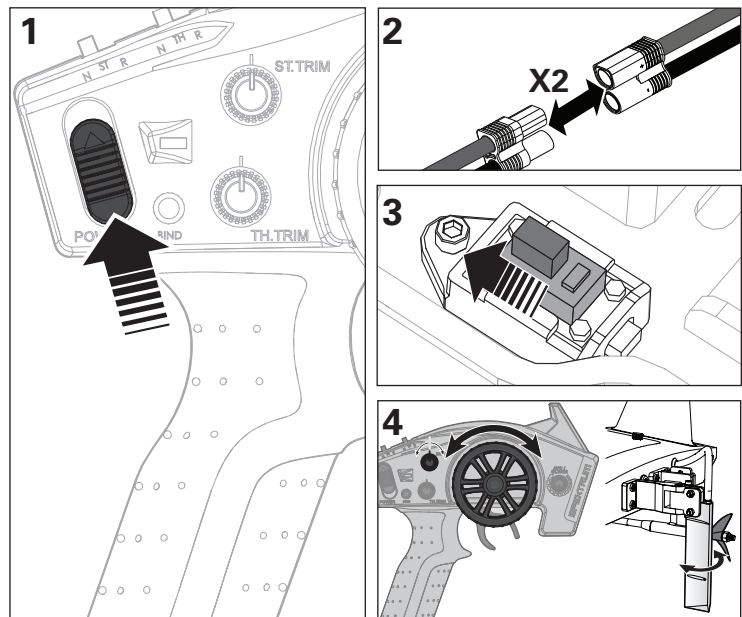

Control Check

IMPORTANT: Perform a control check at the beginning of each boating session, after repair, or after installation of new batteries.

Ensure the receiver antenna is extended properly and all batteries are fully charged.

1. Power ON the transmitter and the boat. **Do not install the boat canopy.**
2. Place the boat securely on the boat stand.

NOTICE: Do not operate the engine without water cooling circulation or damage may result.

3. Check steering and throttle on the transmitter.

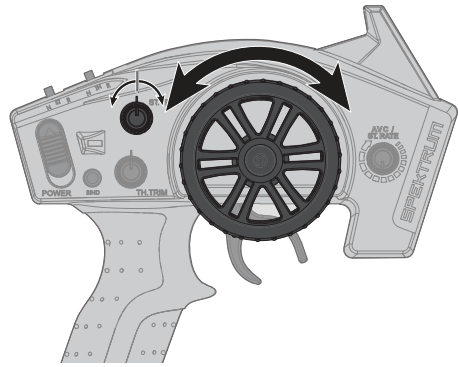

Testing Your Boat in the Water

Tip: Before placing your boat in the water, secure the canopy on the hull. Apply clear tape (DYNAM0102) around the canopy seam, if desired.

1. Carefully place the boat in the water.
2. Operate the boat at slow speeds near the shoreline. Avoid objects in the water at all times. When the boat is moving forward, ensure water flows out of the coolant outlet. Remove any blockage from the rudder inlet and coolant system or the motor and ESC (electronic speed control) may overheat.
3. Once you are comfortable operating the boat at slow speeds, it is safe to operate the boat farther from the shore.
4. If the boat does not go straight, adjust the steering trim dial on the transmitter.

Tip: If you are using excessive steering trim on your transmitter to make the boat drive straight, return the trim to neutral and mechanically center the rudder. To do this, use a 1.5mm hex driver to loosen the set screw holding the push rod to the servo. Adjust the linkage in or out of the brass barrel until the rudder is centered. Tighten the set screw using a 1.5mm hex driver.

5. Bring the boat back to shore when you notice the boat starting to lose speed.
6. Power off the ESC and disconnect the battery packs.
7. Allow the motor, ESC and battery packs to cool before charging the batteries or operating the boat again.

NOTICE: Always power OFF the receiver before powering OFF the transmitter. If the transmitter is powered OFF before the receiver, the receiver will enter failsafe mode.

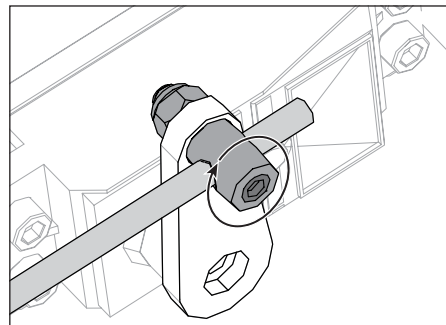

Boating Tips

When running your boat for the first time, we recommend calm wind and water conditions so that you can learn how the boat responds to your control.

Maximum speeds are only achieved when the water conditions are smooth and there is little wind. A sharp turn, wind or waves can turn over a boat when it is moving quickly. Always pilot your boat for the wind and water conditions so that the boat does not turn over.

Consult local laws and ordinances before choosing a location to pilot your boat.

Avoid boating near:

- watercraft
- people (swimming areas, fishing areas)
- stationary objects
- waves, wakes
- rapidly moving water
- wildlife
- floating debris
- overhanging trees
- vegetation

If the propeller and rudder are blocked with debris or vegetation, remove the boat from the water and remove the debris before continuing operation.

When making turns, decrease the throttle to reduce the probability of flipping the boat over. If necessary, adjust your steering input to decrease sensitivity.

Never operate your boat in less than 12 inches (30.5 cm) of water.

If you need to retrieve your boat from the water, use fishing equipment or another boat.

NOTICE: When running at full speed in choppy waters, the prop may exit and re-enter the water repeatedly and very quickly, subjecting the propeller and flex shaft to some stress. Frequent stress may damage the propeller and flex shaft.

CAUTION: Never operate your boat in extreme temperatures or turbulent water.

CAUTION: Never attempt to retrieve a downed boat by swimming.

When You Are Finished

1. Power off the receiver.
2. Power off the transmitter.
3. Disconnect and remove the batteries from the boat.

Tip: Always remove the canopy before storage or moisture may allow mold and mildew to grow in the boat.

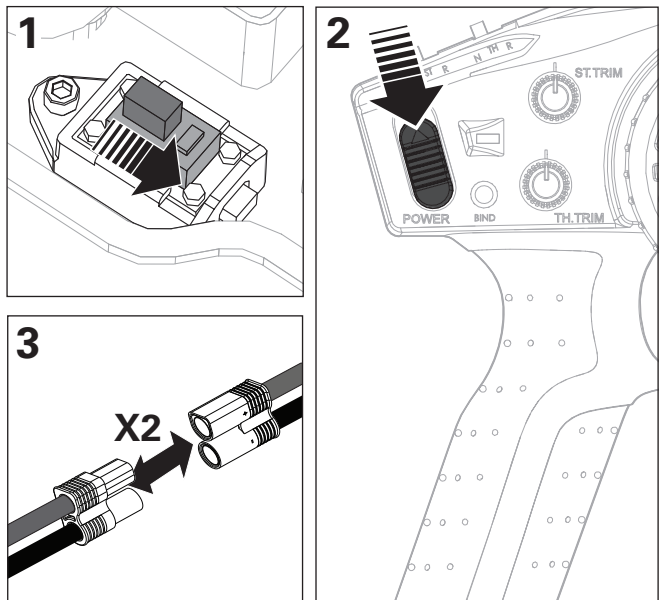

After Boating and Maintenance

- Drain water from inside the hull using the drain plug
- Fully dry the inside and outside of the boat, including the water cooling lines and jacket around the motor. Remove the hatch before storing your boat
- Repair any damage or wear to the boat
- Lubricate the flex shaft using Pro Boat Marine Grease (DYNE4200)
- Make note of lessons learned from the trimming of your boat, including water and wind conditions

Tip: The hook and loop strips in the boat retain water. To dry them, press on them with a dry cloth.

NOTICE: When you are finished boating, never leave the boat in direct sunlight or in a hot, enclosed area such as a car. Doing so can damage the boat.

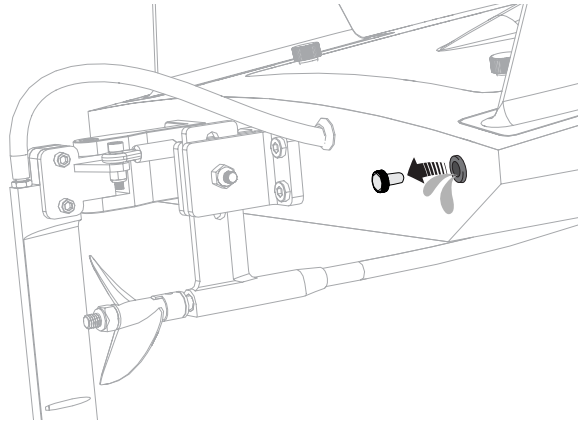

Binding

The included transmitter and receiver are bound at the factory. If you need to rebind, follow the instructions below.

1. Ensure the transmitter and vehicle are both powered OFF.
2. Install the bind plug in the BIND/battery port of the receiver.
3. Power ON the vehicle. The receiver LED will blink.
4. Stand approximately 8–12 feet (2.4–3.7m) from the vehicle. With the steering wheel and throttle trigger in the failsafe positions (neutral), press and hold the bind button and power ON the transmitter. The transmitter's green LED will blink after 3 seconds, indicating it is in bind mode.
5. Release the bind button when the green LED flashes. Continue holding failsafe positions until the binding process is complete.
6. The receiver LED will glow solid when the transmitter and receiver are bound.
7. Power OFF the vehicle, then the transmitter.
8. Remove the bind plug and store it in a convenient place.

The receiver will be bound to the transmitter until another bind process is completed.

If you encounter problems, obey binding instructions and refer to the troubleshooting guide for other instructions. If needed, contact the appropriate Horizon Product Support office.

NOTICE: Do not attempt to bind the transmitter and receiver if there are other compatible transmitters in bind mode within 400 feet. Doing so may result in unexpected binding.

Failsafe

In the unlikely event that the radio connection is lost during use, the receiver will drive the servos to their pre-programmed failsafe positions as set during Binding.

If the receiver is powered on before powering on the transmitter, the receiver will enter this failsafe mode. When the transmitter is powered on, normal control is resumed.

IMPORTANT: Failsafe activates only in the event that signal is lost from the transmitter. Failsafe will NOT activate in the event that receiver battery power decreases below the recommended minimums or power to the receiver is lost.

Motor Care

- Prolong motor life by preventing overheating conditions. Undue motor wear results from frequent turns, stops and starts, pushing objects, boating in rough water or vegetation and boating continuously at high speed.
- Over-temperature protection is installed on the ESC to prevent circuit damage, but cannot protect the motor from excessive physical resistance.

Water Cooling System

If water does not stream out of the water outlets while the boat is moving forward, immediately return the boat to shore and clean any obstructions or remove kinks from the water cooling lines/system.

1. Disassemble and clean the water cooling system to remove blockage and prevent overheating.
2. Replace damaged parts.

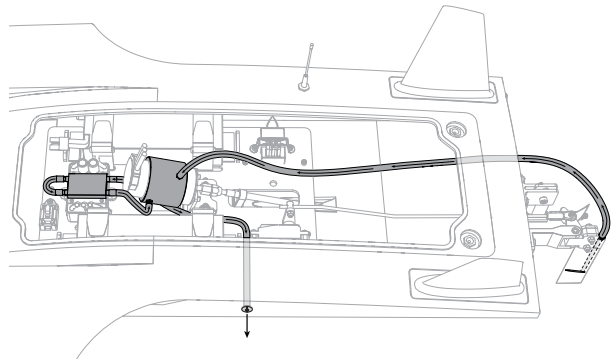

Rudder Service

1. Disconnect the water tube from the rudder.
2. Remove the nut, screw and linkage from the rudder arm.
3. Turn the rudder and loosen the set screw from the rudder pin.
4. Turn over the boat and lightly tap the rudder to remove the pin.
5. Assemble in reverse order.

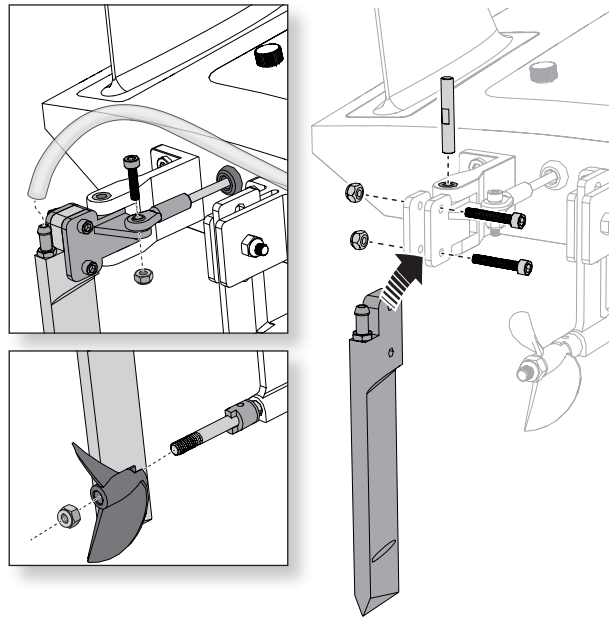

Propeller Service

1. Use an 8mm nut driver (DYN2805) to loosen the nut from the driveshaft. To secure the propeller while loosening the nut, hold the propeller.
2. Remove the nut and propeller from the driveshaft.
3. Assemble in reverse order. Correctly align the propeller with the drive dog on the driveshaft.

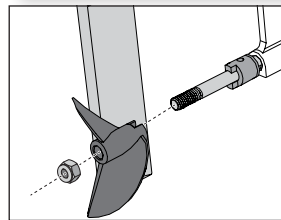

Propeller Strut Depth Adjustment

Raising the propeller strut increases speed but decreases handling.

Lowering the propeller strut increases stability but decreases speed.

1. Use a 3 mm hex driver and 7mm open-end wrench to loosen the propeller strut bolt.
2. Slide the strut up or down to change the angle of the propeller in relation to the hull.
3. Once desired strut depth is achieved, tighten the nuts and bolts.

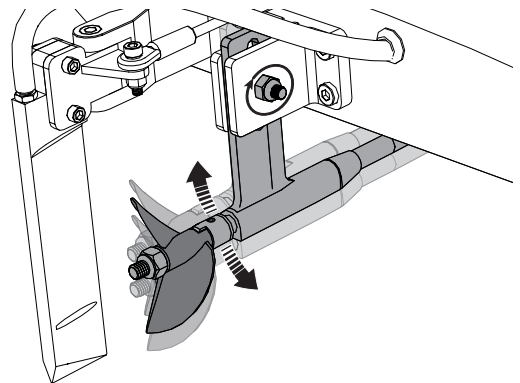

Drivetrain Lubrication

Always replace the drivetrain parts when they are damaged or show visible wear or injury and damage may result.

Lubricating the flex shaft is vital to the life of the drivetrain. The lubricant also acts as a water seal, keeping water from entering the hull through the stuffing tube.

Lubricate the flex shaft and propeller strut after every 30 minutes of operation and/or everytime you change the batteries.

1. Inside the hull, use 2 10mm open-end wrenches to loosen the collet nut from the flex shaft.
2. Slide the flex shaft out from the stuffing tube and drive strut at the rear of the boat.

Tip: Use paper or cloth to touch the flex shaft and other lubricated parts.

3. Wipe the old lubricant and material from the flex shaft.

Tip: Use motor spray (DYN5500) to break down the grease buildup.

4. Lubricate the full length of the flex shaft assembly up to the drive dog using Pro Boat Marine Grease (DYNE4200). Also apply grease to the collet threads.
5. Carefully reinstall the flex shaft in the drive strut, stuffing tube and collet. If the flex shaft is difficult to remove from (or install into) the collet, rotate the flex shaft to the right while pulling it from (or inserting it into) the collet.

NOTICE: Do not rotate the flex shaft to the left inside the coupler.

Ensure there is a 2mm gap between the drive strut and drive dog to allow for flex shaft shrinkage under load.

NOTICE: Running the boat in saltwater could cause some parts to corrode. If you run the boat in saltwater, rinse it thoroughly in freshwater after each use and lubricate the drive system.

NOTICE: Because of its corrosive effects, running RC boats in saltwater is at the discretion of the modeler.

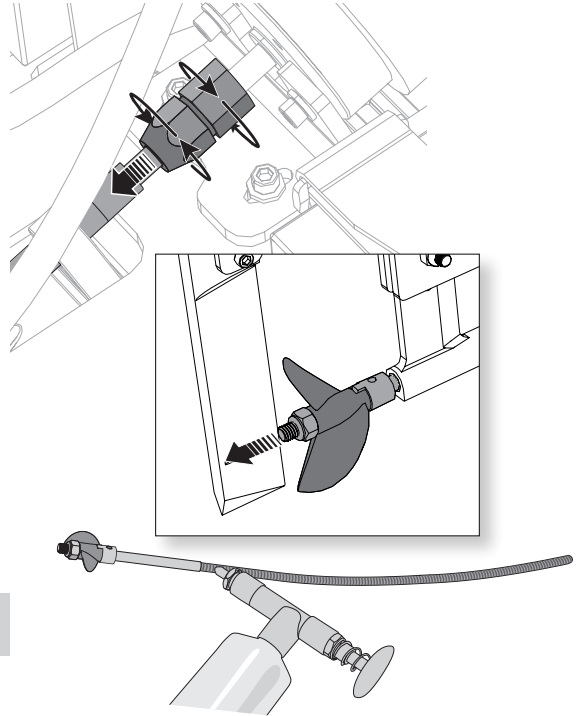

ESC Programming

1. Pull and hold the Throttle Trigger to full throttle and turn the ESC on.
2. After 2 seconds a “-B-B” will sound. Wait another 5 seconds and the ESC will give a rising tone to indicate you have entered **Programming Mode**.
3. After entering Programming Mode, you will hear 4 tones in a loop indicating **Programmable Items**. Push the Throttle Trigger to full brake within 3 seconds after the tone sounds matching the programmable item you want to select.
4. After selecting a programmable item, you will hear several tones in a loop indicating **Programmable Values**. Pull Throttle Trigger to full throttle to select the value matching the tone. The ESC will give an alternating tone to indicate the item is selected.
5. Keep the trigger in Full Throttle to return to **Step 3** and continue item selection. Move the throttle stick to full brake position within 2 seconds to exit the Program Mode.

The black-shaded setting is the factory default

| Programmable Items | Programmable Value | | | | -B Single Beep B— Long Beep | | | |
|---------------------------|--------------------|------------------|-----------|-----------|--------------------------------|----------|------------|--------------|
| | -B | -B-B | -B-B-B | -B-B-B-B | B— | B— -B | B— -B-B | B— -B-B-B |
| Running Mode -B | Forward Only | Forward/Backward | | | | | | |
| Li-Po Cells -B-B | Auto Calc. | 2s | 3s | 4s | 5s | 6s | | |
| Low Voltage Cutoff -B-B-B | None | 2.8V/Cell | 3.0V/Cell | 3.2V/Cell | 3.4V/Cell | | | |
| Timing -B-B-B-B | 0.00° | 3.75° | 7.50° | 11.25° | 15.00° | 18.75° | 22.50° | 26.25° |

Troubleshooting Guide

| Problem | Possible Cause | Solution |
|--|--|--|
| Boat will not respond to throttle but responds to other controls | Throttle channel is reversed | Reverse throttle channel on transmitter |
| Extra noise or extra vibration | Damaged propeller, shaft or motor | Replace damaged parts |
| | Propeller is out of balance | Balance or replace propeller |
| Reduced runtime or boat underpowered | Boat battery charge is low | Completely recharge battery |
| | Boat battery is damaged | Replace boat battery and follow battery instructions |
| | Blocking or friction on shaft or propeller | Disassemble, lubricate and correctly align parts |
| | Boat conditions may be too cold | Make sure the battery is warm (above 10° C [50° F]) before use |
| | Battery capacity may be too low for conditions | Replace battery or use a larger capacity battery |
| | Too little lubrication on driveshaft | Fully lubricate driveshaft |
| Boat will not Bind (during binding) to transmitter | Vegetation or other obstacles block the propeller | Remove vegetation or obstacles from propeller |
| | Transmitter is too near boat during binding process | Move powered transmitter a few feet from boat, disconnect and reconnect battery to boat |
| | Boat or transmitter is too close to large metal object, wireless source or another transmitter | Move the boat and transmitter to another location and attempt binding again |
| | Another compatible transmitter in bind mode within range of the receiver | Power off all compatible transmitters except the one you are trying to bind |
| | Boat battery/transmitter battery charge is too low | Replace/recharge batteries |
| Boat will not connect (after binding) to transmitter | ESC switch is off | Power on ESC switch |
| | Transmitter is too near boat during connecting process | Move powered transmitter a few feet from boat, disconnect and reconnect battery to boat |
| | Boat or transmitter is too close to large metal object, wireless source or another transmitter | Move boat or transmitter to another location and attempt to connect again |
| | Boat battery/transmitter battery charge is too low | Replace/recharge batteries |
| Boat tends to dive in the water or takes on water | ESC switch is off | Power on ESC switch |
| | The boat hull is not completely closed | Dry out the boat and ensure the hatch is fully closed on the hull before returning the boat to the water |
| | Center of gravity is too far forward | Move batteries back in the hull |
| Controls reversed | Transmitter settings are reversed | Do the Control Direction Test and adjust controls on transmitter appropriately |
| Motor overheats | Blocked water cooler lines | Clean, unkink or replace water lines |
| Motor power pulses then motor loses power | ESC uses default soft Low Voltage Cutoff (LVC) | Recharge boat battery or replace battery that is no longer performing |
| | Weather conditions might be too cold | Postpone until weather is warmer |
| | Battery is old, worn out or damaged | Replace battery |
| Boat moves forward or backward without input from user | Throttle trim on transmitter not centered | Adjust throttle trim to center (12 o'clock) |
| Boat does not drive straight | Steering trim on transmitter not centered | Adjust steering trim so vehicle drives straight |
| No steering or lack of steering | Steering rate not adjusted correctly | Adjusts steering rate (ST RATE) knob on transmitter to desired steering throw |
| | Servo failed | Contact Horizon Product Support |
| No throttle or lack of throttle | ESC failed | Contact Horizon Product Support |
| | Motor failed | Contact Horizon Product Support |
| ESC emits a continues tone when powered on | Throttle trim not centered | Center throttle trim on transmitter |

Limited Warranty

What this Warranty Covers

Horizon Hobby, LLC, (Horizon) warrants to the original purchaser that the product purchased (the "Product") will be free from defects in materials and workmanship at the date of purchase.

What is Not Covered

This warranty is not transferable and does not cover (i) cosmetic damage, (ii) damage due to acts of God, accident, misuse, abuse, negligence, commercial use, or due to improper use, installation, operation or maintenance, (iii) modification of or to any part of the Product, (iv) attempted service by anyone other than a Horizon Hobby authorized service center, (v) Product not purchased from an authorized Horizon dealer, or (vi) Product not compliant with applicable technical regulations or (vii) use that violates any applicable laws, rules, or regulations.

OTHER THAN THE EXPRESS WARRANTY ABOVE, HORIZON MAKES NO OTHER WARRANTY OR REPRESENTATION, AND HEREBY DISCLAIMS ANY AND ALL IMPLIED WARRANTIES, INCLUDING, WITHOUT LIMITATION, THE IMPLIED WARRANTIES OF NON-INFRINGEMENT, MERCHANTABILITY AND FITNESS FOR A PARTICULAR PURPOSE. THE PURCHASER ACKNOWLEDGES THAT THEY ALONE HAVE DETERMINED THAT THE PRODUCT WILL SUITABLY MEET THE REQUIREMENTS OF THE PURCHASER'S INTENDED USE.

Purchaser's Remedy

Horizon's sole obligation and purchaser's sole and exclusive remedy shall be that Horizon will, at its option, either (i) service, or (ii) replace, any Product determined by Horizon to be defective. Horizon reserves the right to inspect any and all Product(s) involved in a warranty claim. Service or replacement decisions are at the sole discretion of Horizon. Proof of purchase is required for all warranty claims. SERVICE OR REPLACEMENT AS PROVIDED UNDER THIS WARRANTY IS THE PURCHASER'S SOLE AND EXCLUSIVE REMEDY.

Limitation of Liability

HORIZON SHALL NOT BE LIABLE FOR SPECIAL, INDIRECT, INCIDENTAL OR CONSEQUENTIAL DAMAGES, LOSS OF PROFITS OR PRODUCTION OR COMMERCIAL LOSS IN ANY WAY, REGARDLESS OF WHETHER SUCH CLAIM IS BASED IN CONTRACT, WARRANTY, TORT, NEGLIGENCE, STRICT LIABILITY OR ANY OTHER THEORY OF LIABILITY, EVEN IF HORIZON HAS BEEN ADVISED OF THE POSSIBILITY OF SUCH DAMAGES. Further, in no event shall the liability of Horizon exceed the individual price of the Product on which liability is asserted. As Horizon has no control over use, setup, final assembly, modification or misuse, no liability shall be assumed nor accepted for any resulting damage or injury. By the act of use, setup or assembly, the user accepts all resulting liability. If you as the purchaser or user are not prepared to accept the liability associated with the use of the Product, purchaser is advised to return the Product immediately in new and unused condition to the place of purchase.

Law

These terms are governed by Illinois law (without regard to conflict of law principals). This warranty gives you specific legal rights, and you may also have other rights which vary from state to state. Horizon reserves the right to change or modify this warranty at any time without notice.

WARRANTY SERVICES

Questions, Assistance, and Services

Your local hobby store and/or place of purchase cannot provide warranty support or service. Once assembly, setup or use of the Product has been started, you must contact your local

distributor or Horizon directly. This will enable Horizon to better answer your questions and service you in the event that you may need any assistance. For questions or assistance, please visit our website at www.horizonhobby.com, submit a Product Support Inquiry, or call the toll free telephone number referenced in the Warranty and Service Contact Information section to speak with a Product Support representative.

Inspection or Services

If this Product needs to be inspected or serviced and is compliant in the country you live and use the Product in, please use the Horizon Online Service Request submission process found on our website or call Horizon to obtain a Return Merchandise Authorization (RMA) number. Pack the Product securely using a shipping carton. Please note that original boxes may be included, but are not designed to withstand the rigors of shipping without additional protection. Ship via a carrier that provides tracking and insurance for lost or damaged parcels, as Horizon is not responsible for merchandise until it arrives and is accepted at our facility. An Online Service Request is available at http://www.horizonhobby.com/content/service-center_render-service-center. If you do not have internet access, please contact Horizon Product Support to obtain a RMA number along with instructions for submitting your product for service. When calling Horizon, you will be asked to provide your complete name, street address, email address and phone number where you can be reached during business hours. When sending product into Horizon, please include your RMA number, a list of the included items, and a brief summary of the problem. A copy of your original sales receipt must be included for warranty consideration. Be sure your name, address, and RMA number are clearly written on the outside of the shipping carton.

NOTICE: Do not ship Li-Po batteries to Horizon. If you have any issue with a Li-Po battery, please contact the appropriate Horizon Product Support office.

Warranty Requirements

For Warranty consideration, you must include your original sales receipt verifying the proof-of-purchase date. Provided warranty conditions have been met, your Product will be serviced or replaced free of charge. Service or replacement decisions are at the sole discretion of Horizon.

Non-Warranty Service

Should your service not be covered by warranty, service will be completed and payment will be required without notification or estimate of the expense unless the expense exceeds 50% of the retail purchase cost. By submitting the item for service you are agreeing to payment of the service without notification. Service estimates are available upon request. You must include this request with your item submitted for service. Non-warranty service estimates will be billed a minimum of ½ hour of labor. In addition you will be billed for return freight. Horizon accepts money orders and cashier's checks, as well as Visa, MasterCard, American Express, and Discover cards. By submitting any item to Horizon for service, you are agreeing to Horizon's Terms and Conditions found on our website http://www.horizonhobby.com/content/service-center_render-service-center.

ATTENTION: Horizon service is limited to Product compliant in the country of use and ownership. If received, a non-compliant Product will not be serviced. Further, the sender will be responsible for arranging return shipment of the un-serviced Product, through a carrier of the sender's choice and at the sender's expense. Horizon will hold non-compliant Product for a period of 60 days from notification, after which it will be discarded.

Warranty and Service Contact Information

| Country of Purchase | Horizon Hobby | Contact Information | Address |
|--------------------------|---|---|--|
| United States of America | Horizon Service Center (Repairs and Repair Requests) | servicecenter.horizonhobby.com/RequestForm/ | 4105 Fieldstone Rd Champaign, Illinois, 61822 USA |
| | Horizon Product Support (Product Technical Assistance) | productsupport@horizonhobby.com 877-504-0233 | |
| | Sales | websales@horizonhobby.com 800-338-4639 | |
| EU | Horizon Technischer Service | service@horizonhobby.eu | Hanskampring 9 D 22885 Barsbüttel, Germany |
| | Sales: Horizon Hobby GmbH | +49 (0) 4121 2655 100 | |

FCC Information

FCC ID: BRWDSTX1 This device complies with part 15 of the FCC rules. Operation is subject to the following two conditions:

- (1) This device may not cause harmful interference, and
- (2) This device must accept any interference received, including interference that may cause undesired operation.

CAUTION: Changes or modifications not expressly approved by the party responsible for compliance could void the user's authority to operate the equipment.

This product contains a radio transmitter with wireless technology which has been tested and found to be compliant with the applicable regulations governing a radio transmitter in the 2.400GHz to 2.4835GHz frequency range.

IC Information

IC ID: 6157A-STX1 This device complies with Industry Canada licence-exempt RSS standard(s). Operation is subject to the following two conditions: (1) this device may not cause interference, and (2) this device must accept any interference, including interference that may cause undesired operation of the device.

Antenna Separation Distance

When operating your Spektrum transmitter, please be sure to maintain a separation distance of at least 5 cm between your body (excluding fingers, hands, wrists, ankles and feet) and the antenna to meet RF exposure safety requirements as determined by FCC regulations.

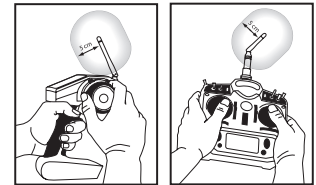

The following illustrations show the approximate 5 cm RF exposure area and typical hand placement when operating your Spektrum transmitter.

CE EU Compliance Statement: Horizon Hobby, LLC hereby declares that this product is in compliance with the essential requirements and other relevant provisions of the RED and EMC Directives.

A copy of the EU Declaration of Conformity is available online at: <http://www.horizonhobby.com/content/support-render-compliance>.



Instructions for Disposal of WEEE by Users in the European Union

This product must not be disposed of with other waste. Instead, it is the user's responsibility to dispose of their waste equipment by handing it over to a designated collection point for the recycling of waste electrical and electronic equipment. The separate collection and recycling of your waste equipment at the time of disposal will help to conserve natural resources and ensure that it is recycled in a manner that protects human health and the environment. For more information about where you can drop off your waste equipment for recycling, please contact your local city office, your household waste disposal service or where you purchased the product.

Replacement Parts / Ersatzteile / Pièces de rechange / Pezzi di ricambio

| Part # | English | Deutsch | Français | Italiano |
|-----------|-------------------------------------|-----------------------------------|---------------------------------------|--|
| DYNM3831 | 3650 6 Pole Marine Motor 2000Kv | 3650 6-poliger Bootsmotor 2000 kv | Moteur 3650 6 Pôles Marine 2000Kv | Motore marino 6 poli 3650 2000 Kv |
| DYNM3875 | Dynamite 120A BL Marine ESC 2-6S | 120A Bootsempfänger 2-6 | Contrôleur Brushless 120A 2-6S | ESC marino brushless 120 A 2-6S |
| PRB281053 | Hull | Rumpf | Coque | Scafo |
| PRB281054 | Canopy | Kabinenhaube | Cockpit | Capottina |
| PRB281055 | Vertical Fins | Vertikale Lamellen | Dérives | Pinne verticali |
| PRB281056 | Rudder | Seitenruder | Gouvernail | Timone |
| PRB281057 | Turn Fin | Wendeflosse | Stabilisateur latéral | Deriva orientabile |
| PRB282046 | Flex Shaft | Flexwelle | Flexible | Albero di trasmissione flessibile |
| PRB282047 | Propeller: 1.7 x 1.6 | Propeller: 1,7 x 1,6 | Hélice 1,7 x 1,6 | Elica: 1,7 x 1,6 |
| PRB285000 | ProBoat Break-away screw, nylon | ProBoat Abbrechschraube, Nylon | Écrou de sécurité en nylon Pro Boat | Vite sganciabile ProBoat, nylon |
| PRB286047 | Prop Strut | Propellerstrebe | Chaise d'hélice | Supporto esterno asse dell'elica |
| PRB286048 | Rudder Pushrod Set | Rudergestängesatz | Tringlerie de gouvernail | Set aste di comando timone |
| SPM2330 | DX2E 2Ch DSMR Surface Radio w/SR310 | DX2E 2Ch DSMR Funkgerät mit SR310 | Émetteur DX2E 2 voies DSMR avec SR310 | Radio di superficie DX2E 2 canali DSMR con SR310 |
| SPMSR310 | SR310 3-CH Sport Receiver | SR310 3-CH Sportempfänger | Récepteur Sport SR310 3 voies | Sport SR310 3 canali |

Recommended Parts / Empfohlene Teile / Pièces recommandées / Pezzi consigliati

| Part # | English | Deutsch | Français | Italiano |
|------------|---|---|---|--|
| DYN2801 | Nut Driver: 4mm | Mutterndreher: 4mm | Tournevis p/écrou: 4mm | Cacciavite a bussola: 4 mm |
| DYN2803 | Nut Driver: 5.5mm | Mutterndreher: 5,5mm | Tournevis p/écrou: 5,5mm | Cacciavite a bussola: 5,5 mm |
| DYN2805 | Nut Driver: 8mm | Mutterndreher: 8mm | Tournevis p/écrou: 8mm | Cacciavite a bussola: 8 mm |
| DYN2819 | 5 pc Metric Hex Driver Assortment | 5-teiliges metrisches Inbusschlüssel-Set | Assortiment de 5 tournevis hexagonaux métriques (5pcs) | Set 5 pz. chiavi a brugola metriche |
| DYNB3855EC | Reaction HD7.6V 5000mAh 2S 50C LiPo Hardcase: EC5 | Reaction HD 7,6V 5000mAh 2S 50C Li-Po, Etui: EC5 | Batterie Li-Po Reaction HD 2S 7,6V 5000mA 50C, boîtier rigide avec prise EC5 | Batteria LiPo hardcase Reaction HD 50C 2S 7,6 V 5000 mAh: EC5 |
| DYNB3856EC | Reaction HD 11.4V 5000mAh 3S 50C LiPo,Hardcase: EC5 | Reaction HD 11,4V 5000mAh 3S 50C Li-Po, Etui: EC5 | Batterie Li-Po Reaction HD 3S 11,4V 5000mA 50C, boîtier rigide avec prise EC5 | Batteria LiPo hardcase Reaction HD 50C 3S 11,4 V 5000 mAh: EC5 |
| DYNC0031 | EC5 Device Charge Lead, 12AWG | EC5 Geräteladekabel, 12AWG | Câble de charge EC5, 12AWG | Cavo caricabatteria EC5, 12AWG |
| DYNC3005 | Passport Duo 400W Dual AC/DC Touch Charger | Passport Duo 400 W Duales AC/DC-Touch-Ladegerät | Chargeur Passport Duo 400W AC/DC, écran tactile | Caricabatteria AC/DC Passport Duo 400 W con touch screen |
| DYN4071 | Li-Po Cell Voltage Checker | Li-Po-Zelle Spannungsprüfer | Testeur de tension d'élément Li-Po | Strumento controllo voltaggio batterie LiPo |
| DYNE4200 | Grease Gun with Marine Grease 5 oz | Fettpresse mit Marine Grease 142 g (5 oz) | Pistolet avec graisse marine 140g | Pistola sparagrasso con grasso marino 5 oz |
| DYNK0300 | Hook & Loop Tape Set, WP 75x25mm 4pcs | Klettbandsatz, Wasserfest 75 x 25 mm, 4 Stück | Adhésif auto-agrippant 75x25mm (4pcs) | Nastro a strappo, waterproof, 75 x 25 mm 4 pz. |
| DYNM0102 | Clear Flexible Marine Tape (18M) | Transparentes, flexibles Marine Tape (18 m) | Adhésif Marin transparent flexible (18M) | Nastro marino flessibile trasparente (18 m.) |
| DYNS3005 | Dynamite LED Program Card | Dynamite LED-Programmkarte | Carte de programmation à DELs pour bateau | Scheda di programmazione LED Dynamite |



Optional Parts / Diverse Teile / Pièces optionnelles / Pezzi opzionali

| Part # | English | Deutsch | Français | Italiano |
|------------|---|---|--|--|
| DYNB3810EC | Reaction HD 7.4V 5000mAh 2S 50C LiPo, Hardcase: EC5 | Reaction 7,4 V 5000 mAh 2S 50C Li-Po, Etui: EC5 | Batterie Reaction Li-Po 2S 7,4V 5000mA 50C, boîtier rigide avec prise EC5 | Batteria LiPo hardcase Reaction HD 50C 2S 7,4 V 5000 mAh: EC5 |
| DYNB3811EC | Reaction HD 11.1V 5000mAh 3S 50C LiPo, Hardcase:EC5 | Reaction HD 11,1 V 5000 mAh 3S 50C Li-Po, Etui: EC5 | Batterie Reaction Li-Po 3S 11,1V 5000mA 50C, boîtier rigide avec prise EC5 | Batteria LiPo hardcase Reaction HD 50C 3S 11,1 V 5000 mAh: EC5 |
| DYNC0028 | EC5 Battery Series Harness, 10ga | Kabelbaum für EC5 Akkureihe, 10ga | Cordon EC5 pour branchement en série, 10ga | Cavi batteria EC5, 10ga |
| DYNC3000 | Passport Ultra 100W ACDC Touch Battery Charger | Passport Ultra 100 W AC/ DC-Touch-Akkuladegerät | Chargeur Passport Ultra 100W ACDC écran tactile | Caricabatteria AC/DC Passport Ultra 100 W con touch screen |
| DYN4401 | GPS Speed Meter | GPS-Tachometer | Tachymètre GPS | Tachimetro GPS |
| DYNE4201 | Marine Grease 5 oz | Marine Grease 142 g (5 oz) | Graisse marine 140g | Grasso marino 5 oz |
| DYNT0502 | Start Up Tool Set | Anfänger-Werkzeugsatz | Set d'outils de démarrage | Set attrezzi |
| PRB282006 | Propeller, Stainless Steel, 1,6 x 1,6 for 3/16 shaft | Propeller, Edelstahl, 1,6 x 1,6 für 3/16 Welle | Hélice, acier inoxydable, 1,6 x 1,6 pour arbre 3/16 | Elica, acciaio inossidabile, 1,6 x 1,6 per albero 3/16 |
| PRB282027 | Left Propeller: 1.4x1.65 | Linker Propeller 1,4 x 1,65 | Hélice gauche 1,4 x 1,65 | Elica sinistra: 1,4 x 1,65 |
| SPMS605 | 9KG Servo, WP, Metal, 23T | 9KG Servo, WP, Metallf, 23T | Servo 9Kg à pignons métalliques, étanche, tête 23T | Servo 9 kg., waterproof, metallo, 23T |
| SPMMR4000 | MR4000 DSMR 4 Ch Marine Receiver | MR4000 DSMR 4 Ch Bootsempfänger | Récepteur MR4000 4 voies marin | Ricevente marina MR4000 DSMR 4 canali |
| SPMSS6250 | S6250 High Torque, HV Dig Servo | S6250 Digitaler HV-Servo mit hoher Drehzahl | Servo S6250 Digital HV, couple élevé | Servo digitale HV S6250 high torque |

53738.1

Updated: 07/2017

©2017 Horizon Hobby LLC.

Pro Boat, the Pro Boat logo, DSMR, EC5, Dynamite, Reaction, Passport and the Horizon Hobby logo are trademarks or registered trademarks of Horizon Hobby, LLC. The Spektrum trademark is used with permission of Bachmann Industries, Inc. All other trademarks, service marks and logos are property of their respective owners.