

## Driveshaft Assembly and Service

Covers Parts #5450, 5451, 5452, 5455, 5459

### Driveshaft Removal

1. Remove the wheel from the axle by removing the wheel nut and sliding the wheel and tire off of the axle. Slide the hex hub adapter off of the axle and push the axle pin out of the axle.
2. Remove the screw pin from the diff output yoke and slide the output yoke and driveshaft off of the differential output shaft.
3. Collapse the two ends of the driveshaft together and pull the axle out of the hub carrier from the inside. Remove the entire driveshaft assembly from the suspension.



Installation of the driveshaft assembly is performed in the reverse order.

### U-joint Disassembly/Assembly

1. Remove a small E-clip from the smaller cross pin in the universal joint and push the pin out of the U-joint and drive yoke from the other side.
2. Push the larger pin out of the U-joint and drive yoke to complete disassembly.



For the assembly of the U-joint and drive yoke, perform these steps in the reverse order.

Once the driveshaft is disassembled, examine the ends of the shafts to make sure the small plugs are still located inside the holes. These plugs keep dirt out of the shafts.

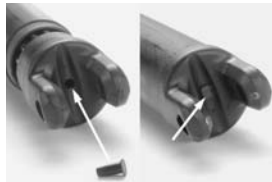

For convenience, the half shaft assemblies are available with pre-glued rubber boots as part #5450.

### Driveshaft Rubber Boot Service

If the rubber dust boot located on the driveshaft becomes torn, Traxxas recommends replacing the dust boot to keep dirt out of the splined sliders and maintain top performance. Follow the steps below for proper dust boot maintenance.

1. Remove the torn dust boot from both of the driveshaft ends and clean the shafts with denatured alcohol to remove any left over dirt and glue.

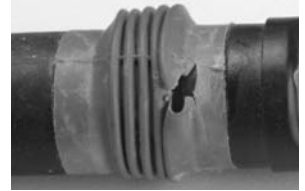

2. First, slide a new dust boot over the female slider and position the end of the boot over the indicated area (see picture). Next, slide the female slider over the male slider until it meets the dust boot. Revo's driveshafts are splined for optimum durability and performance. The male and female shafts are manufactured to key into each other only one way. The yokes at each end must be of the same orientation (see below).



3. Stretch the end of the dust boot over the male end to the line indicated in the picture.

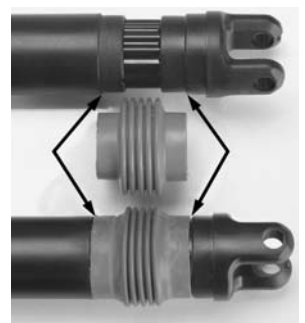

4. Once both ends are positioned on the each slider shaft, allow the assembly to rest naturally on a table before gluing. Apply a small amount of thin CA glue (tire glue) to the ends of the dust boot so it covers the entire edge of each end of the dust boot. Quickly wipe away any excess glue. Allow the glue to cure before installing the driveshaft assembly back into the truck.



If you have questions or need technical assistance, call Traxxas at

## 1-888-TRAXXAS

(1-888-872-9927) (U.S. residents only)

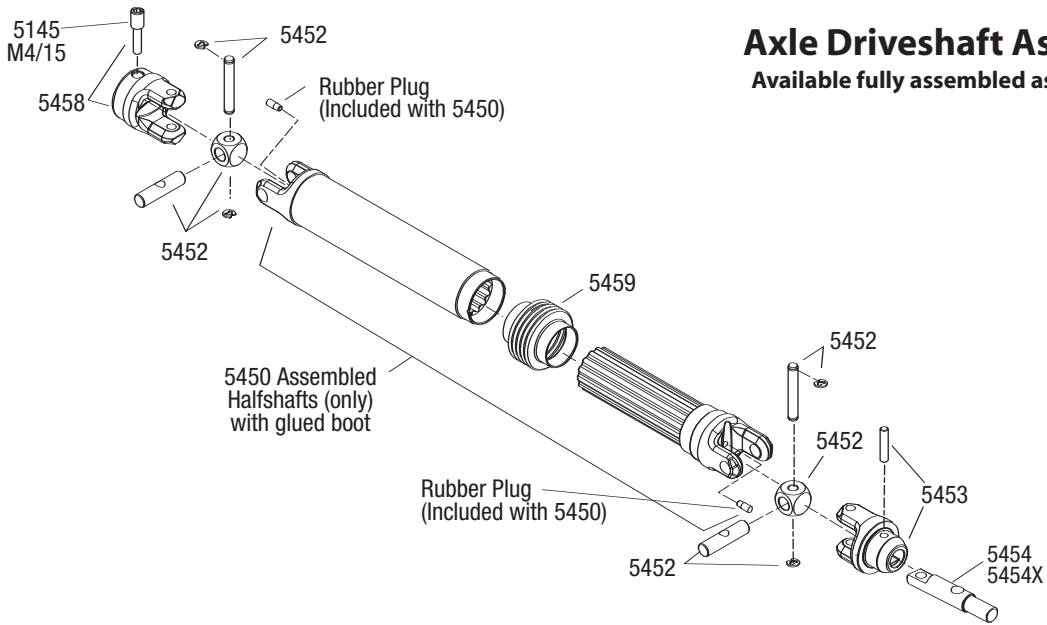

## Axle Driveshaft Assembly

Available fully assembled as part #5451

### DRIVESHAFT PARTS LIST

Parts shown in bold are optional accessories.

5145	Screw pin, 4x15mm (6).....	3.50	5450	Half shaft set, left or right (plastic parts only) (internal splined half shaft/ external splined half shaft/rubber boot) (assembled with glued boot) (2 assemblies).....	7.50
5458	Yokes, differential and transmission (2)/ 4x15mm screw pins (2).....	4.00	5459	Boots, driveshaft (rubber) (2) .....	2.50
5452	U-joints, driveshaft (carrier (4)/ 4.5mm cross pin (4)/ 3mm cross pin (4)/ E-clips (20)) (metal parts for 2 driveshafts) .....	10.00	5453	Yokes, stub axle (2)/ pins (2) .....	4.00
			5454	Stub axle (steel) (2) .....	5.00
			<b>5454X</b>	<b>Stub axle (titanium) (4) .....</b>	<b>TBA</b>